

Cabinet Specifications:

Width (mm): 2117
Depth (mm): 680
Height (mm): 716
Weight (kg): 145

Electrical Power (kW): 0.105
Electrical Voltage (V): 240
Electrical Ampere (A): 0.44
Electrical Frequency (Hz): 50

MEPS TEC (kW): 7.64
Refrigerant: R134a
Heat Load (kW): 0

Refrigeration in Power: 0.63kW @ -5C

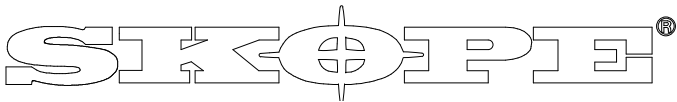
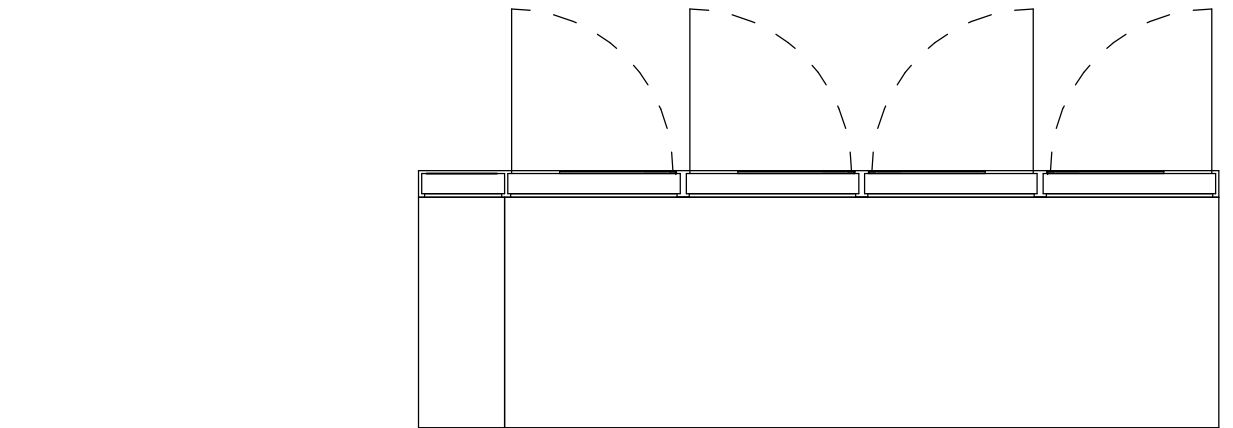
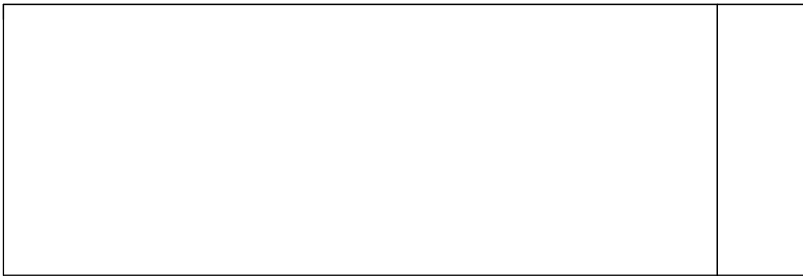
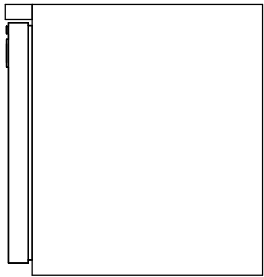
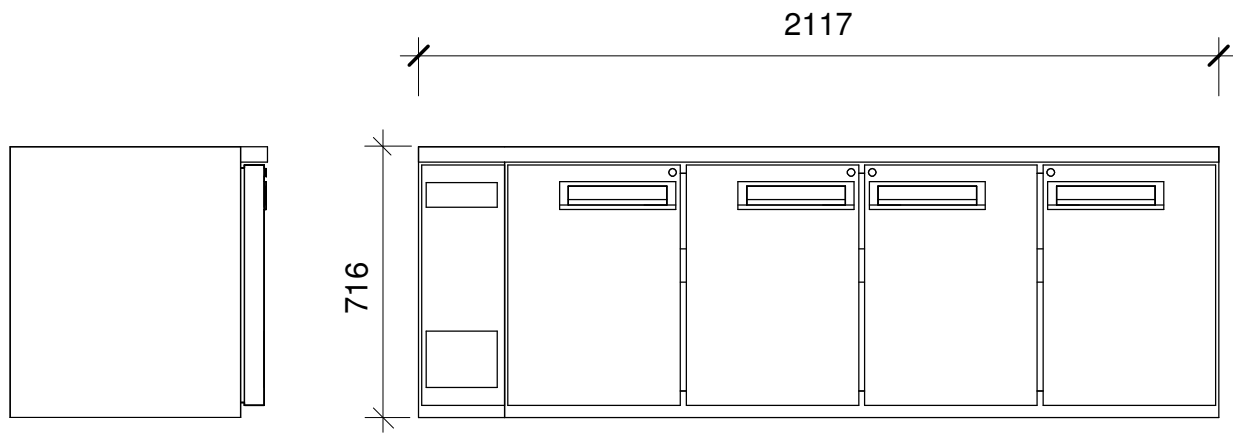

Industries Limited

66 Princess St. PO Box 1091
Christchurch, New Zealand
New Zealand Freephone: 0900 947 5673
Australian Freephone: 1800 121 535
Email: enquiry@skope.co.nz
Website: www.skope.co.nz

Model: PG550HCr		
Description: Horizontal, 4 door High Performance Gastronorm Chiller with Remote, LH refrigeration services		
Unless Otherwise Specified		Scale 1:20
Folded Dimensions:	Overall +/- 0.5mm	Revision -.-
Linear Tolerances:	+/- 0.5°	
Angular Tolerances:	Millimetres	
Units:		
Copyright © SKOPE Industries Limited		